

Wes Vice Hardwoods
& Supply Inc.
Nederland, Texas



Miscellaneous
Mouldings

SPECIFICATIONS

MOULDING # PLTH 1

CUSTOMER: _____

COMMENTS: 20* HOOK

MOULDER: 5/16 T-REX CORR., 1.5 START DEPTH, 10MM AXIALS
T-REX LONG WEAR

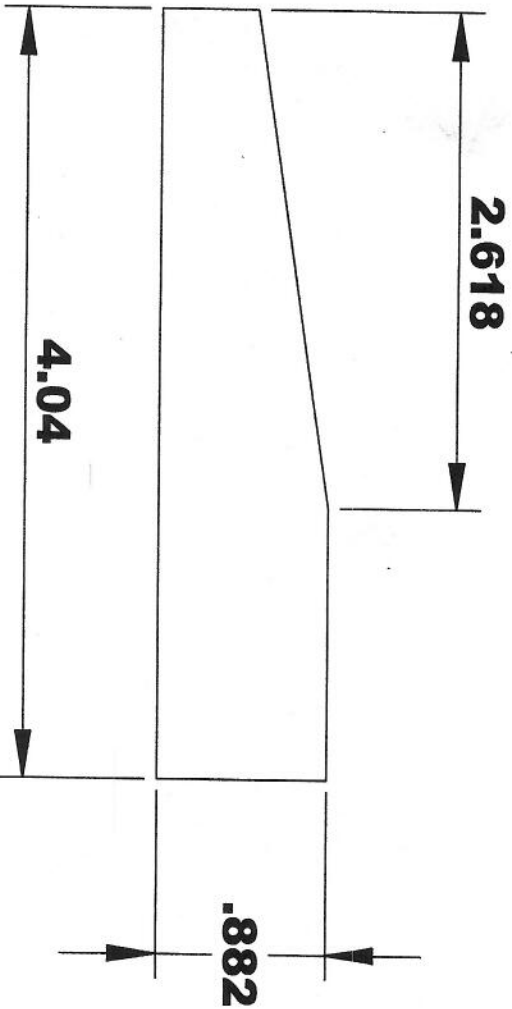

INSIDE OF MACHINE

OUTFEED VIEW COMING

SPECIFICATIONS

MOULDING # MISC 1

CUSTOMER:

COMMENTS: 20 * HOOK

MOULDER: 5/16 T-REX CORR., 1.5 START DEPTH, 10MM AXIALS
T-REX LONG WEAR

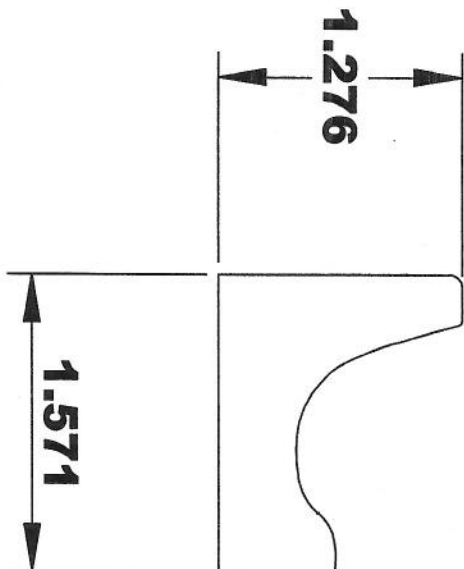

INSIDE OF MACHINE

OUTFEED VIEW COMING

SPECIFICATIONS

MOULDING # **CO 2**

CUSTOMER: _____

COMMENTS: **20* HOOK**

MOULDER: 5/16 T-REX CORR., 1.5 START DEPTH, 10MM AXIALS
T-REX LONG WEAR

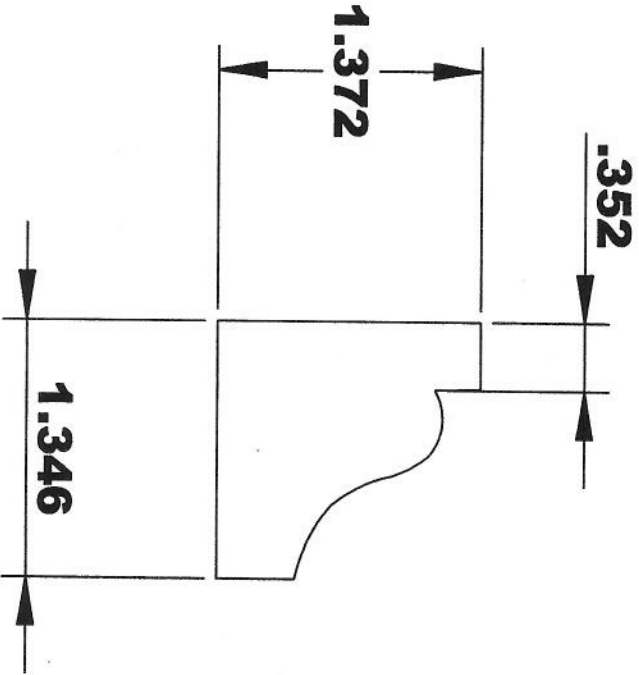

INSIDE OF MACHINE

OUTFEED VIEW COMING

SPECIFICATIONS

MOULDING # CO 3

CUSTOMER: _____

COMMENTS: 20* HOOK

MOULDER: 5/16 T-REX CORR, 1.5 START DEPTH, 10MM AXIALS
T-REX LONG WEAR

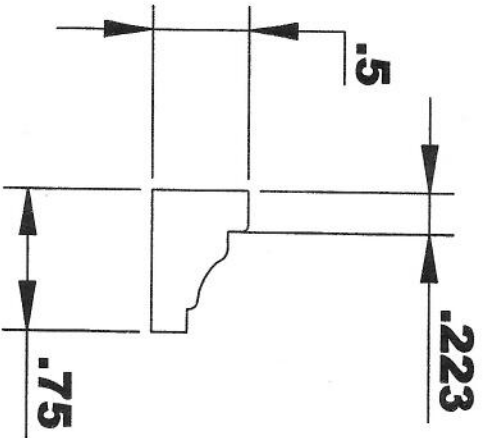

INSIDE OF MACHINE

OUTFEED VIEW COMING

SPECIFICATIONS

MOULDING # **TS-CO 3**

CUSTOMER: _____

COMMENTS: **20 * HOOK**

MOULDER: 5/16 T-REX CORR., 1.5 START DEPTH, 10MM AXIALS

T-REX LONG WEAR

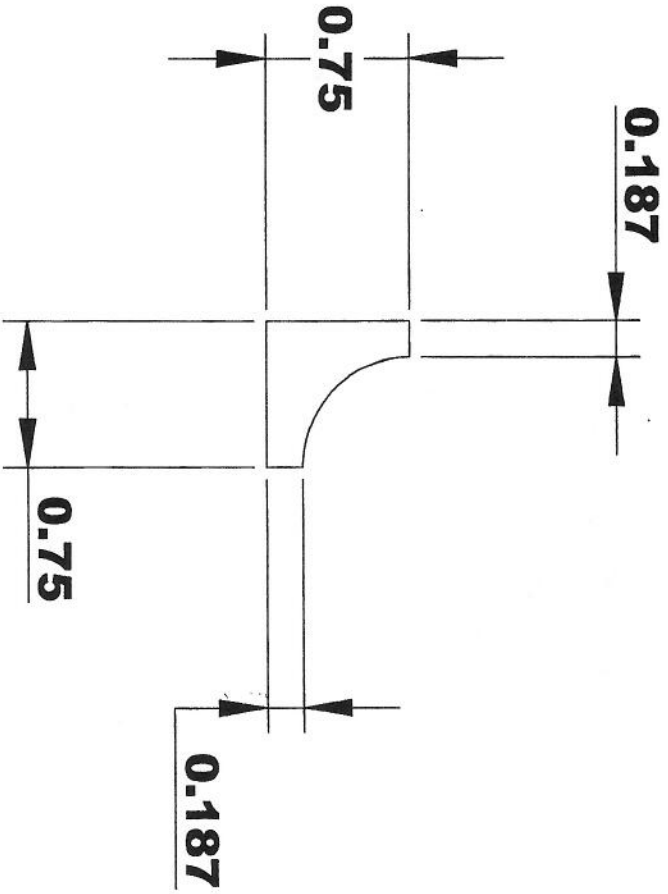

INSIDE OF MACHINE

OUTFEED VIEW COMING

SPECIFICATIONS

MOULDING # CO 4

CUSTOMER: _____

COMMENTS: 20° HOOK

MOULDER: 5/16 T-REX CORR., 1.5 START DEPTH, 10MM AXIALS
T-REX LONG WEAR

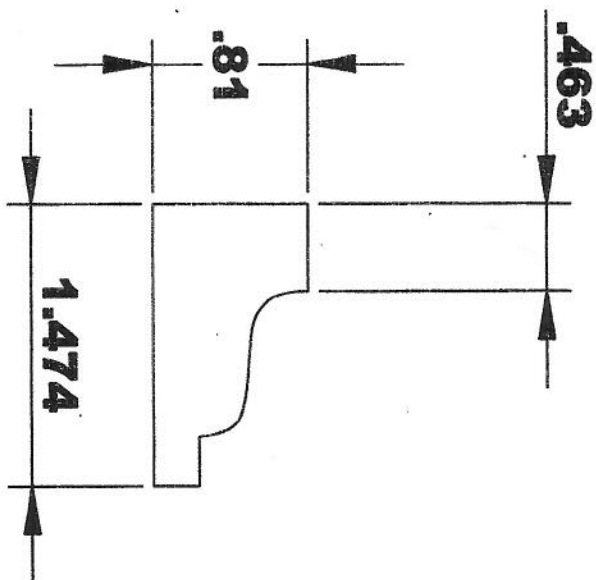

INSIDE OF MACHINE

OUTFEED VIEW COMING

SPECIFICATIONS

MOULDING # **CO 5**

CUSTOMER: _____

COMMENTS: **20* HOOK**

MOULDER: 5/16 T-REX CORR., 1.5 START DEPTH, 10MM AXIALS
T-REX LONG WEAR

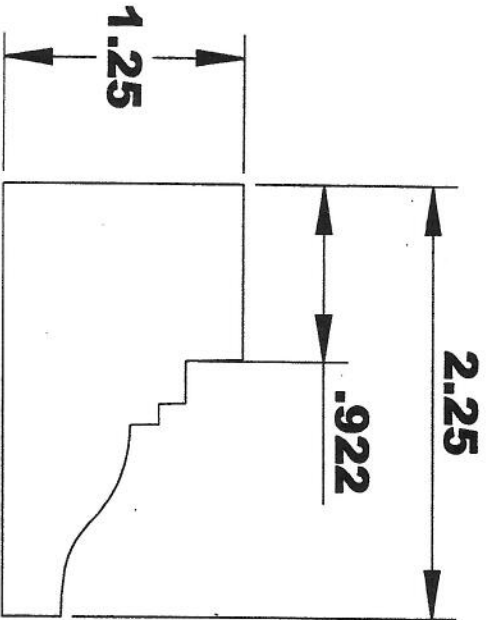

INSIDE OF MACHINE

OUTFEED VIEW COMING

SPECIFICATIONS

MOULDING # **CO 6**

CUSTOMER: _____

COMMENTS: **20* HOOK**

MOULDER: 5/16 T-REX CORR., 1.375 START DEPTH, 10MM AXIALS
T-REX LONG WEAR

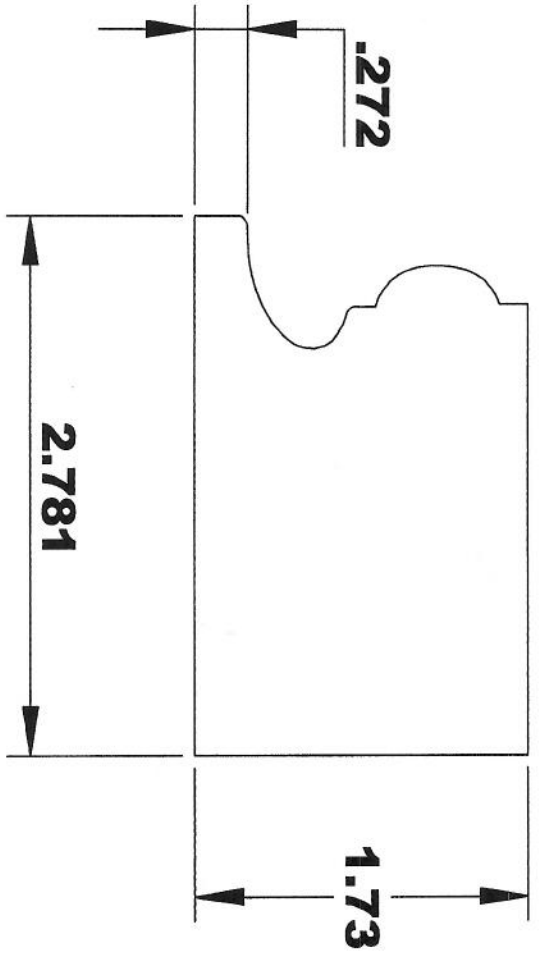

INSIDE OF MACHINE

OUTFEED VIEW COMING

SPECIFICATIONS

MOULDING # TS-CO 6

CUSTOMER: _____

COMMENTS: 20* HOOK

MOULDER: 5/16 T-REX CORR., 1.5 START DEPTH, 10MM AXIALS

T-REX LONG WEAR

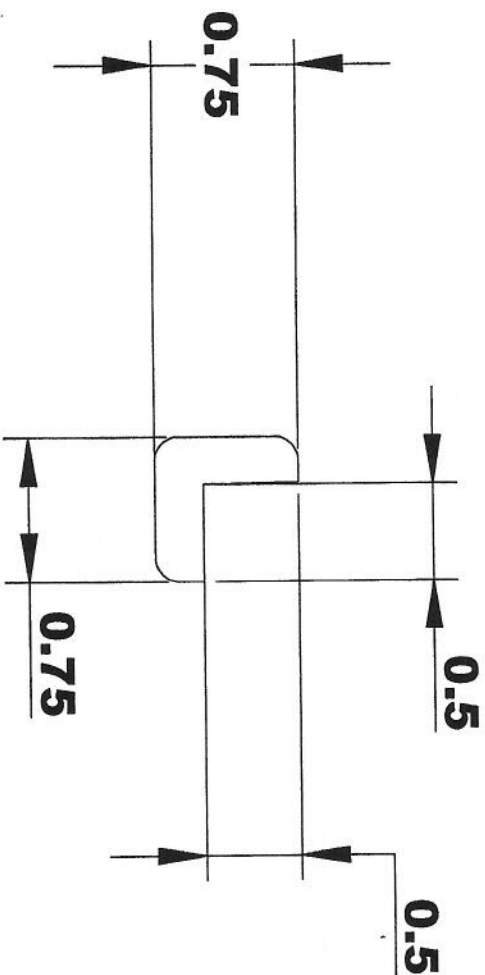

INSIDE OF MACHINE

OUTFEED VIEW COMING

SPECIFICATIONS

MOULDING # CO 7

CUSTOMER: _____

COMMENTS: 15* HOOK

MOULDER: 5/16 T-REX CORR., 1.5 START DEPTH, 10MM AXIALS
T-REX LONG WEAR

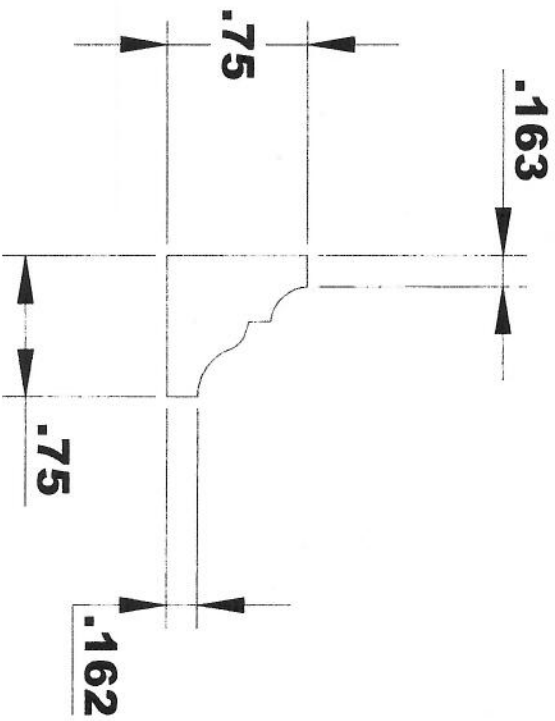

INSIDE OF MACHINE

OUTFEED VIEW COMING

SPECIFICATIONS

MOULDING # MISC 2

CUSTOMER:

COMMENTS: 20* HOOK

MOULDER: 5/16 T-REX CORR., 1.5 START DEPTH, 10MM AXIALS

T-REX LONG WEAR

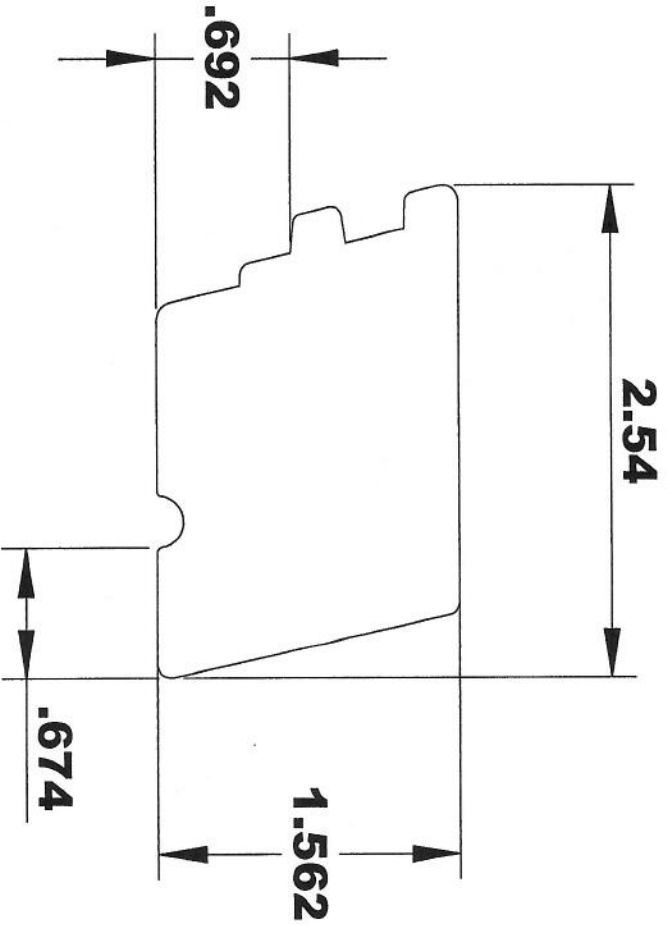
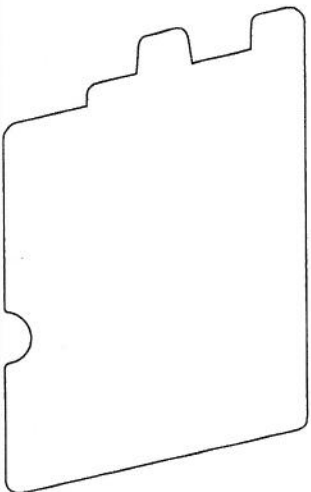

INSIDE OF MACHINE

OUTFEED VIEW COMING

SPECIFICATIONS

MOULDING # SHOE 1

CUSTOMER: _____

COMMENTS: 20* HOOK

MOULDER: 5/16 T-REX CORR., 1.5 START DEPTH, 10MM AXIALS

T-REX LONG WEAR

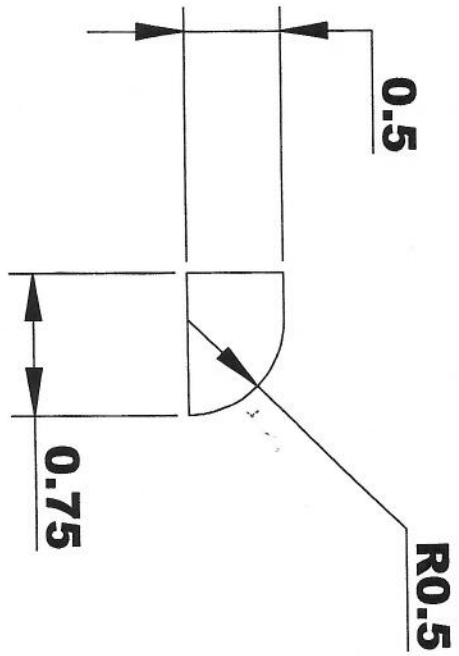

INSIDE OF MACHINE

OUTFEED VIEW COMING

SPECIFICATIONS

MOULDING # _____ SHOE 2

CUSTOMER: _____

COMMENTS: _____ 20* HOOK

MOULDER: 5/16 T-REX CORR., 1.5 START DEPTH, 10MM AXIALS
T-REX LONG WEAR

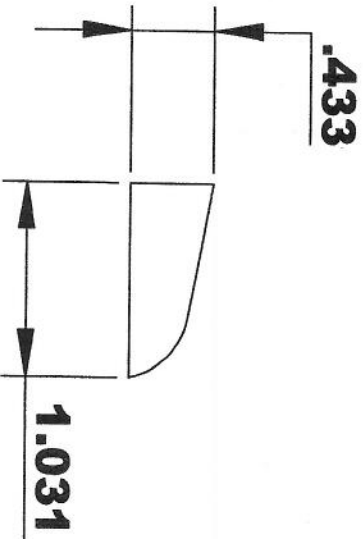

INSIDE OF MACHINE

OUTFEED VIEW COMING

SPECIFICATIONS

MOULDING # _____ SHOE 3

CUSTOMER: _____

COMMENTS: _____ 20 * HOOK

MOULDER: 5/16 T-REX CORR., 1.375 START DEPTH, 10MM AXIALS
T-REX LONG WEAR

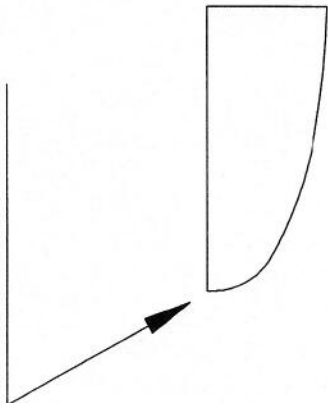
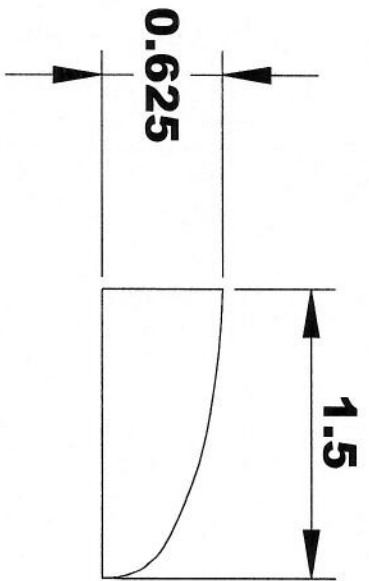

**CAUTION: KNIVES VERY
CLOSE TO BEDPLATE.
CONSIDER USING
SACRIFICIAL BEDPLATE**

INSIDE OF MACHINE

OUTFEED VIEW COMING

SPECIFICATIONS

MOULDING # **SHOE 4**

CUSTOMER: _____

COMMENTS: **20 * HOOK**

MOULDER: 5/16 T-REX CORR., 1.375 START DEPTH, 10MM AXIALS

T-REX LONG WEAR

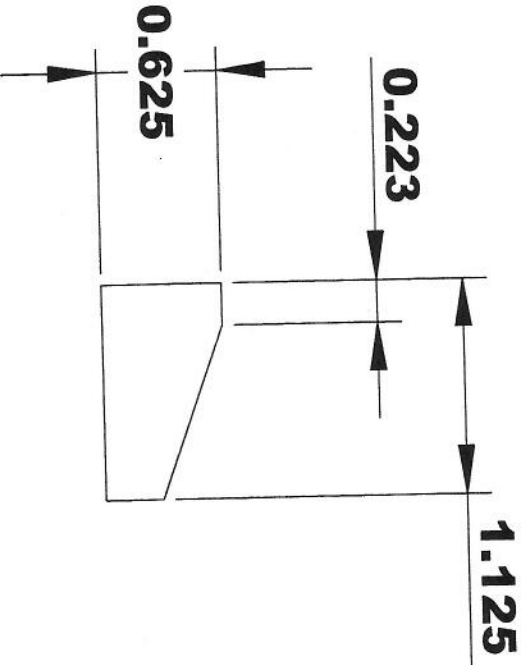

INSIDE OF MACHINE

OUTFEED VIEW COMING

SPECIFICATIONS

MOULDING # **SCRB 1**

CUSTOMER: _____

COMMENTS: **20 * HOOK**

MOULDER: 5/16 T-REX CORR., 1.5 START DEPTH, 10MM AXIALS

T-REX LONG WEAR

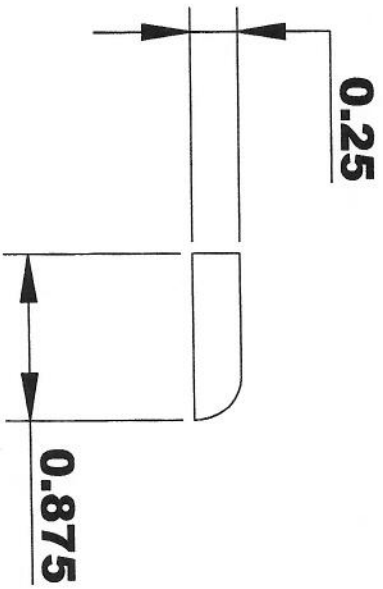

INSIDE OF MACHINE

OUTFEED VIEW COMING

SPECIFICATIONS

MOULDING # **SCRB 2**

CUSTOMER: _____

COMMENTS: **20* HOOK**

MOULDER: 5/16 T-REX CORR., 1.5 START DEPTH, 10MM AXIALS

T-REX LONG WEAR

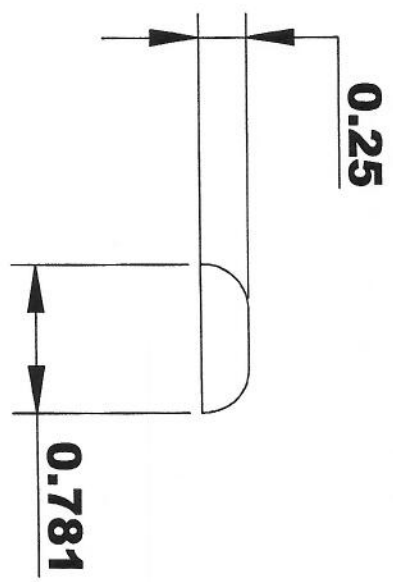

INSIDE OF MACHINE

OUTFEED VIEW COMING

SPECIFICATIONS

MOULDING # HLF RD 1.5

CUSTOMER: _____

COMMENTS: 20* HOOK

MOULDER: 5/16 T-REX CORR., 1.5 START DEPTH, 10MM AXIALS

T-REX LONG WEAR

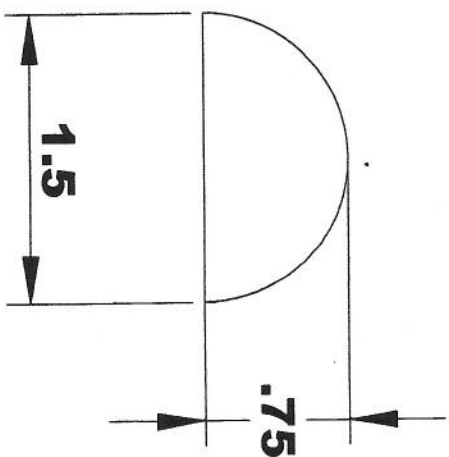

INSIDE OF MACHINE

OUTFEED VIEW COMING

SPECIFICATIONS

MOULDING # QTR RD .75

CUSTOMER: _____

COMMENTS: 20° HOOK

MOULDER: 5/16 T-REX CORR., 1.5 START DEPTH, 10MM AXIALS

T-REX LONG WEAR

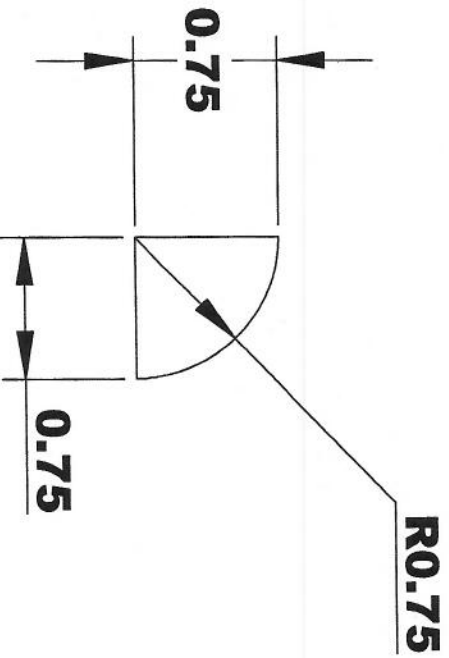

INSIDE OF MACHINE

OUTFEED VIEW COMING

SPECIFICATIONS

MOULDING # RO 1

CUSTOMER: _____

COMMENTS: 20* HOOK

MOULDER: 5/16 T-REX CORR., 1.5 START DEPTH, 10MM AXIALS
T-REX LONG WEAR

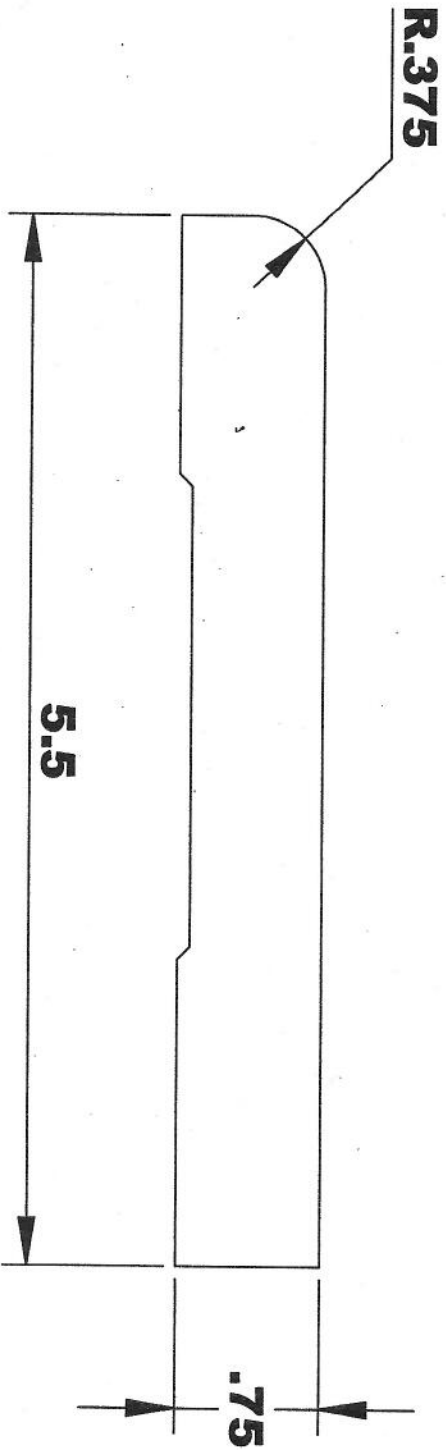

INSIDE OF MACHINE

OUTFEED VIEW COMING

SPECIFICATIONS

MOULDING # RO 1

CUSTOMER: _____

COMMENTS: 20 * HOOK

MOULDER: 5/16 T-REX CORR., 1.5 START DEPTH, 10MM AXIALS
T-REX LONG WEAR

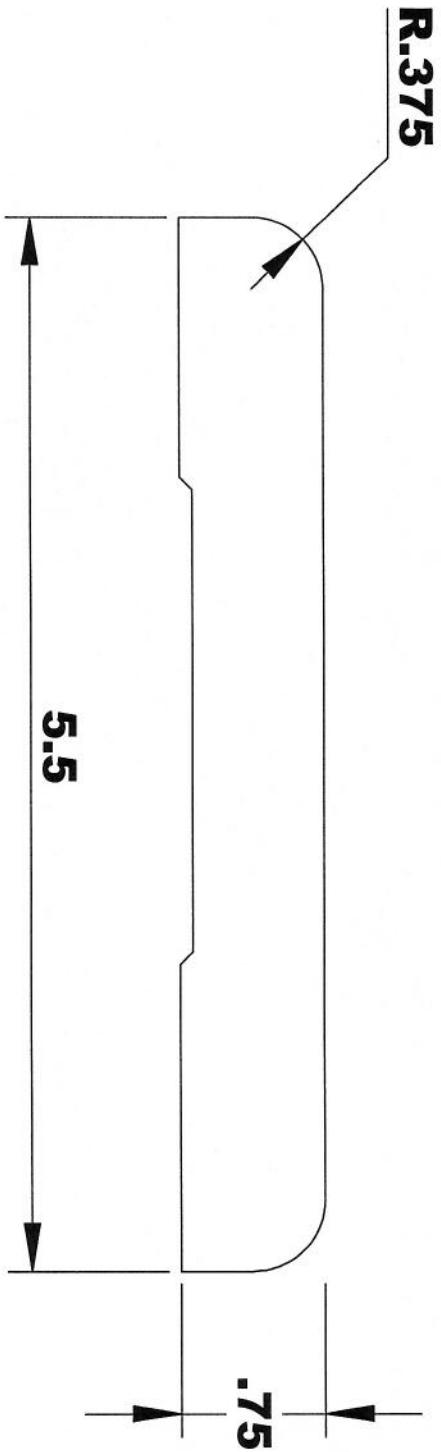

INSIDE OF MACHINE

OUTFEED VIEW COMING

SPECIFICATIONS

MOULDING # CO 7

CUSTOMER: _____

COMMENTS: 20* HOOK

MOULDER: 5/16 T-REX CORR., 1.375 START DEPTH, 10MM AXIALS
T-REX LONG WEAR

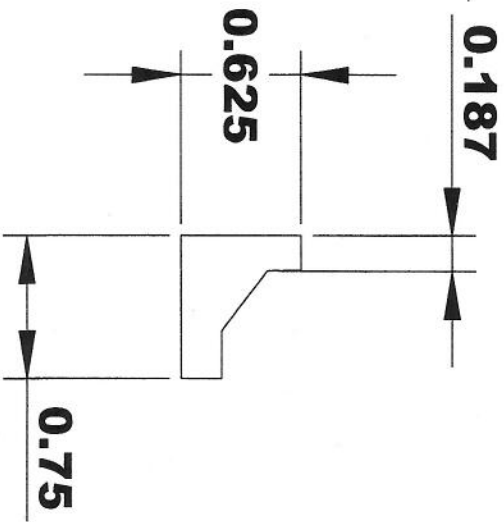

INSIDE OF MACHINE

OUTFEED VIEW COMING

SPECIFICATIONS

MOULDING # **PA 22**

CUSTOMER: _____

COMMENTS: **20 * HOOK**

MOULDER: 5/16 T-REX CORR., 1.375 START DEPTH, 10MM AXIALS

T-REX LONG WEAR

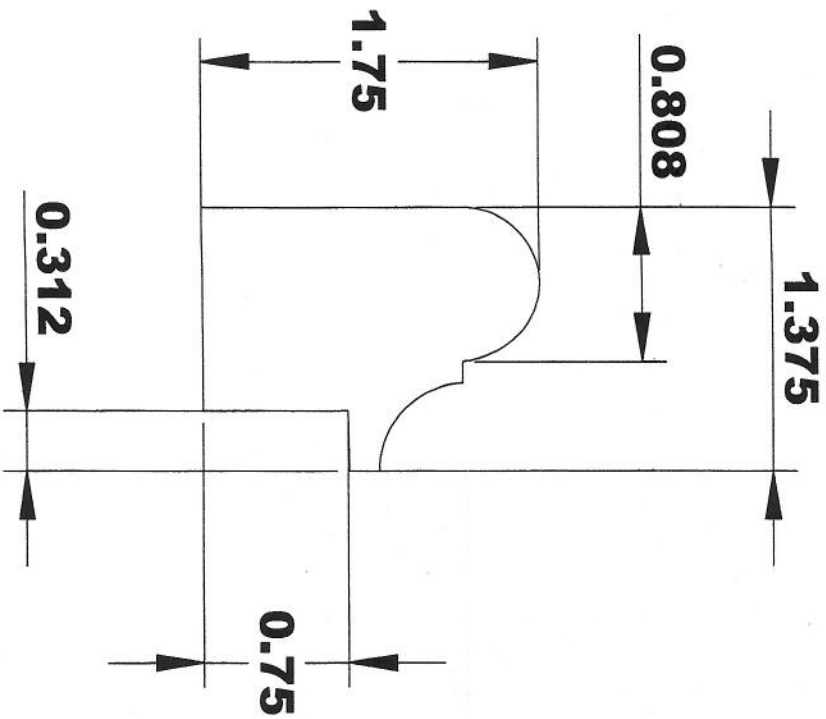

INSIDE OF MACHINE

OUTFEED VIEW COMING

SPECIFICATIONS

MOULDING # PL 23

CUSTOMER: _____

COMMENTS: 20* HOOK

MOULDER: 5/16 T-REX CORR., 1.375 START DEPTH, 10MM AXIALS
T-REX LONG WEAR

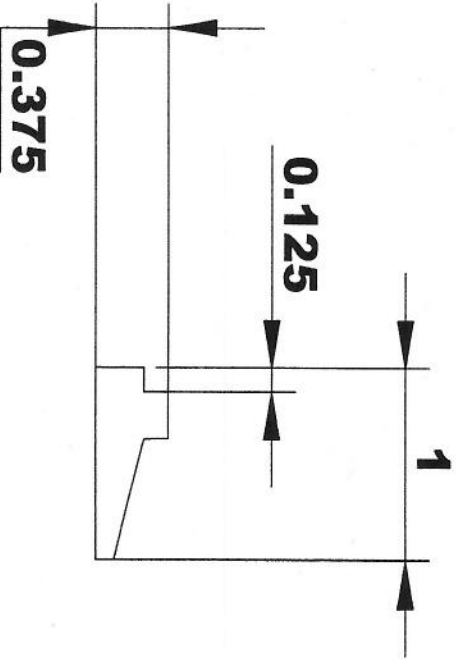

INSIDE OF MACHINE

OUTFEED VIEW COMING